

ARC CURBLESS SHOWERS

THE NEW NORMAL

ARC_{inc.}

DESIGNED AND BUILT ON A

TrueDEKTM

SHOWER FOUNDATION



ARC CURBLESS SHOWERS USING TRUEDEK FOUNDATIONS

- The nation's leading curbless shower system
- Structural base + drain + waterproofing system

TrueDEK™ Installation Steps

ARC inc.

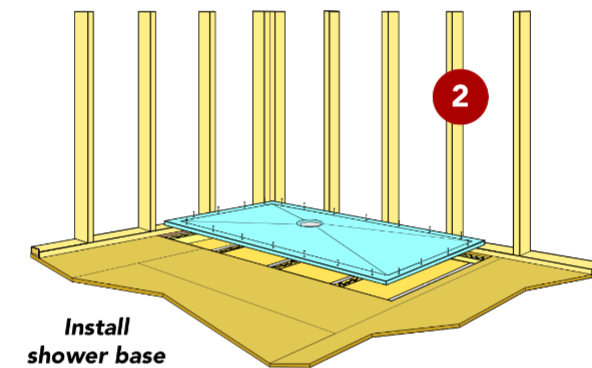
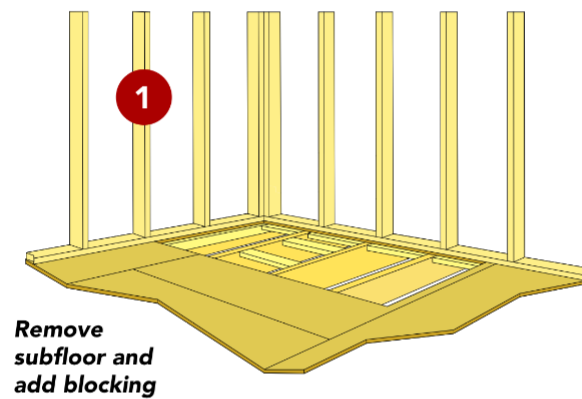

**STRUCTURAL &
PRE-PITCHED**

Go to www.arcfirst.net
for detailed, step-by-step
installation instructions

**LEVEL
ENTRY**

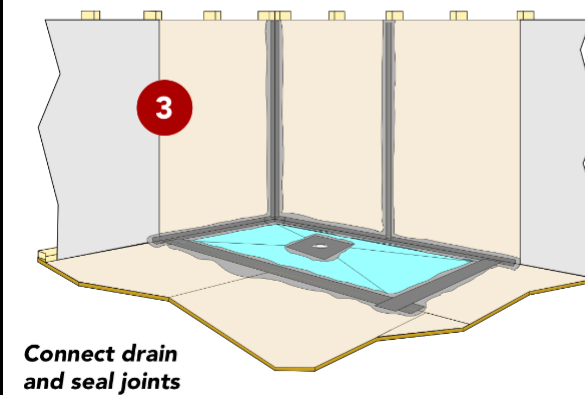

**READY FOR
TILE OR STONE**

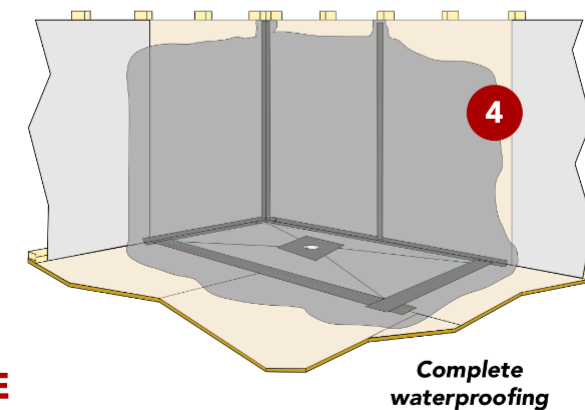

CURBLESS
SHOWER
DESIGN IS THE
'NEW NORMAL'



WHO IS CHOOSING TO GO CURBLESS?

- People from all ages are choosing to go curbless
- America and Canada are among the last countries to still install curbs in residential shower applications



CURBLESS SHOWERS FROM HOUZZ

- All Houzz curbless showers promote design over functionality but in reality, both are on display.

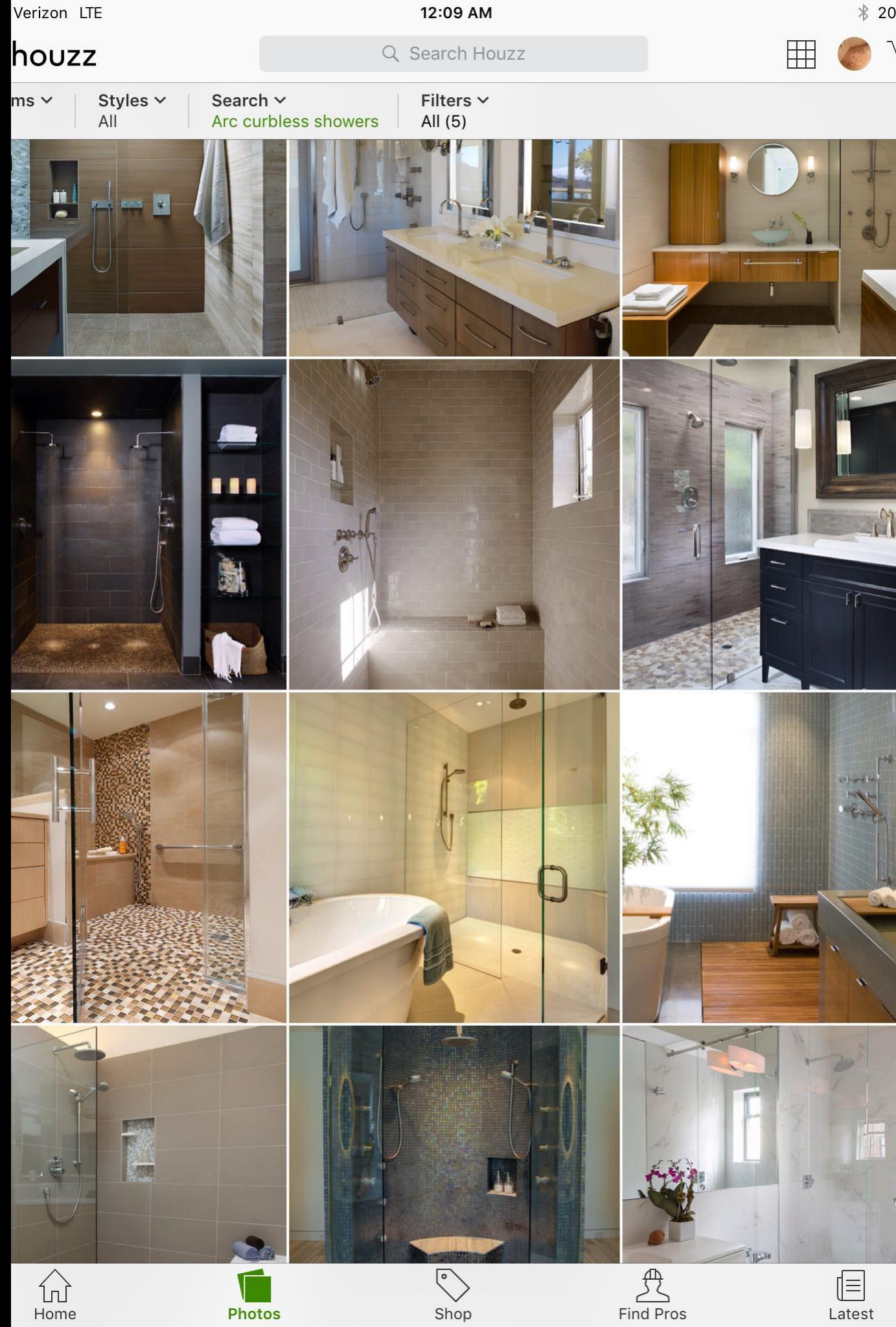

WHY GO CURBLESS?

- Provides a very stylish, clean & sleek look
- Makes your bathroom look and feel 20%-30% larger
- Much easier to clean
- Achieves a Future proof bathroom



WHAT IS A FUTURE PROOF BATHROOM?

- Shower is curbless
- Plywood backing throughout entire shower area walls
- Waterproof entire wall system and floor area



WHY DO I NEED TO FUTURE PROOF MY BATHROOM?

- Every bathroom should be future proofed
- "We cannot predict the future but we can design for it"
- If any additional costs are incurred when achieving a future proof bathroom, those costs should be considered an insurance policy as to not have to spend thousands of dollars down the road if an unexpected situation requires removal of the curb.



WHAT WAS THE PURPOSE OF A CURB IN A SHOWER?

- The curb is designed to do 2 things
- 1) Allows pitch to be created within the shower to get water to the drain.
- 2) Keeps water within the shower area. This is needed because the actual shower base, including the drain, is **HIGHER** than the rest of the bathroom floor so any water that gets out - stays out.



CURBLESS

- True curbless showers that are done correctly always have the drain set as the **LOWEST** part of the bathroom floor
- Because the ARC TrueDek foundations are pre-pitched & structural, the drain becomes the lowest point of the floor without having to modify the structure-ability of your floor assembly.



HOW DO YOU KEEP WATER WITHIN THE SHOWER IF YOU DON'T HAVE A CURB?

- Because the pitch always starts from the highest part of the floor and flows down to the drain which is the lowest part of the floor, 99% of the water goes down the drain.
- A little overspray is of no concern because your bathroom floor is also waterproof.
- No shower door needed as long as there is a sufficient heat source.

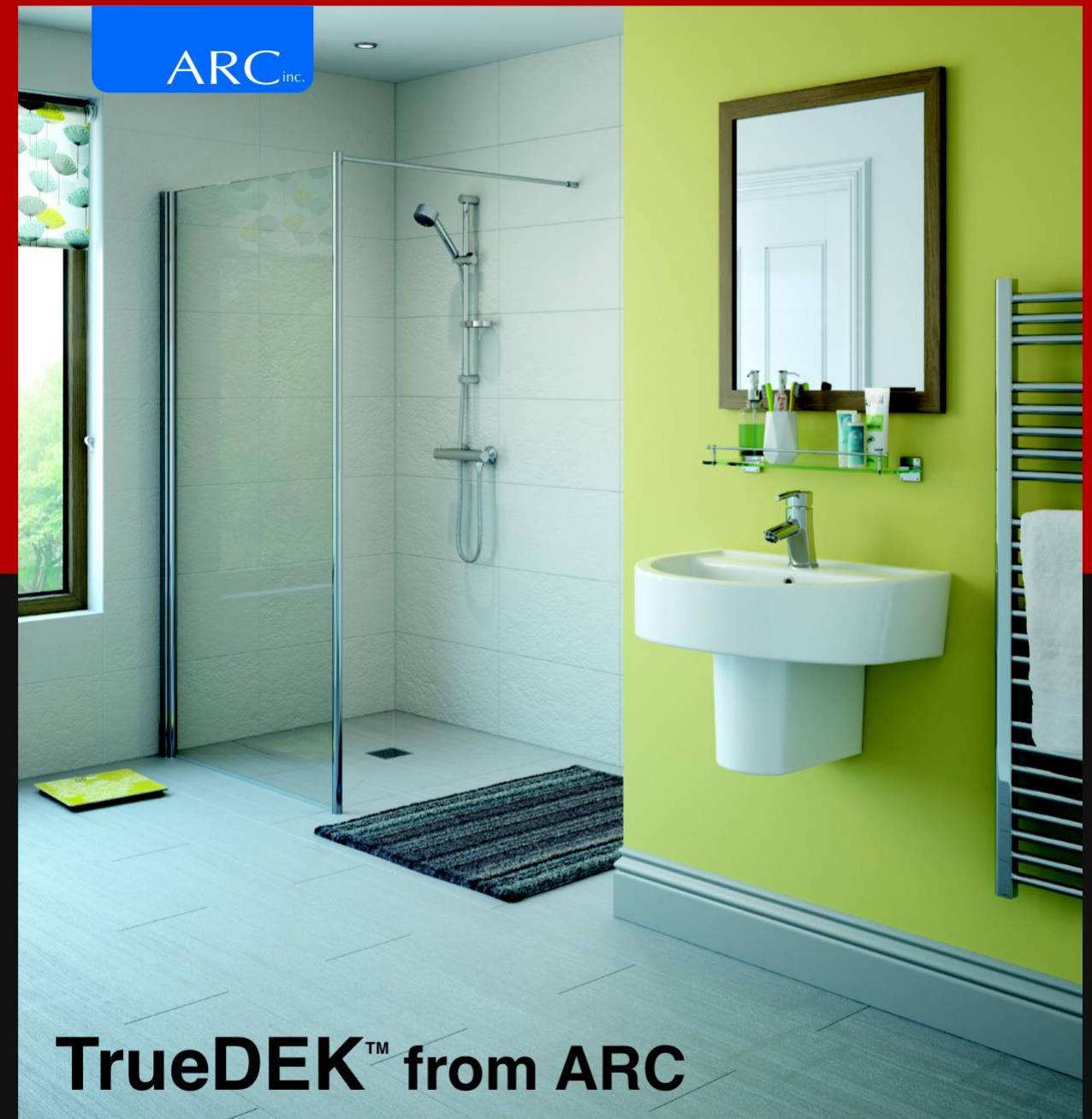

TrueDEK™ from ARC

ARC's TrueDEK pre-pitched foundations provide the structural backbone of today's exceptional level-entry shower designs.

ARC TRUEDEK SHOWER FOUNDATIONS
THE BEST WAY TO ACHIEVE
'CURBLESS'



4 EASY INSTALLATION STEPS

- Cut out subfloor
- Install base
- Reinforce critical joints with tape
- Waterproof entire shower

curbless



DESIGN

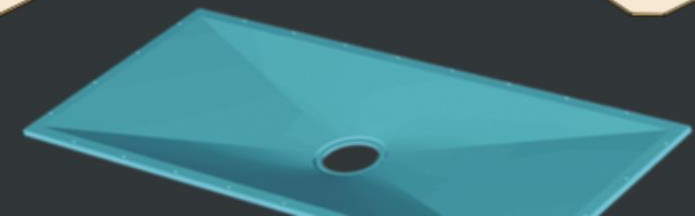
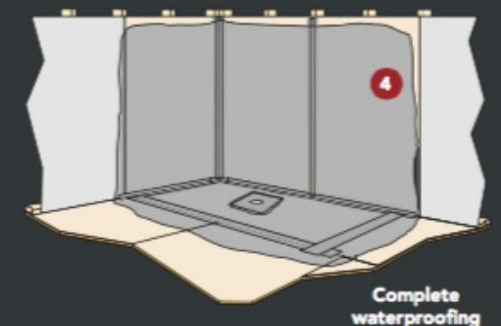
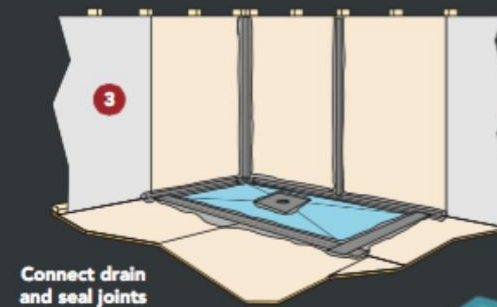
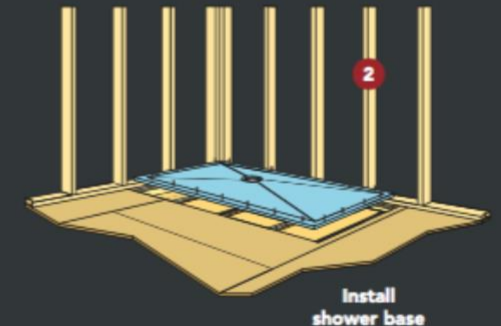
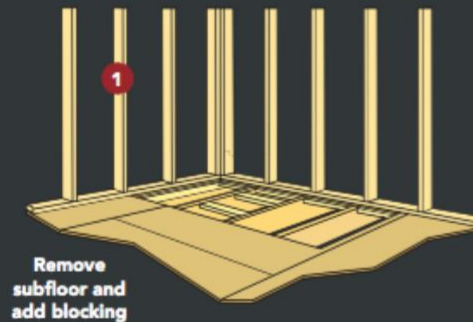

ACTUAL STEP BY STEP INSTALLATION OF TRUEDEK SYSTEM



REMOVE SUBFLOOR



ADD BLOCKING TO SUPPORT
PAN



INSTALL PAN



WATERPROOF ENTIRE
SHOWER



TILE SHOWER



ARC TRUEDEK BASES

- Contain a lifetime warranty
- Tile can be removed from the base down the road without damaging the base or affecting the warranty as long as it's done within the ARC guidelines
- The base becomes a fixture in your home



DESIGN
WITHOUT
BARRIERS

ARC_{inc.}

go
CURBLESS

ask us how